



Fitting and Recoding Instructions

Combi-Bolt 4™

Flush Fitting



1. Using the bolt and keep as a template mark the screw positions. Drill pilot holes for the screws. (Use 3.5mm drill bit).
2. Use the security screw provided and firmly screw into position. (Note these security screws cannot be undone).

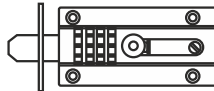

Recess Fitting (Where required)

3. After fitting the bolt use it to position the keep plate. Mark it's position and recess it into the frame.
4. Drill the pilot holes as in 1. above and, using the security screws, secure the keep plate.

How to recode

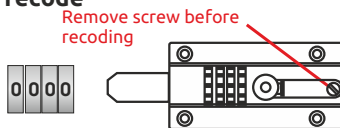

1. The bolt is factory set on 0000. Before you can recode the CombiBolt4 you need to remove the screw marked in the diagram above.

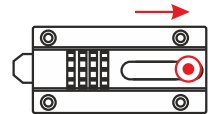

2. Once the screw has been removed draw the bolt back to its stop position. Lift the bolt knob and draw back to a second stop position. Push it down to lock it in this recoding position.



3. Carefully rotate the coding wheels to the desired number, taking care to align them to the coding mark. (Make a note of the new code number).

Without moving the wheels reverse the procedure of 1. The new code is now set.

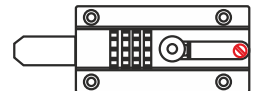

4. Put the security screw back.

Remember

On external installations always lock the bolt even in the open position (This will prevent unauthorised recoding).

Henry Squire & Sons Limited

Hilton Cross Business Park, Cannock Road, Featherstone, Wolverhampton, WV10 7QZ

Tel: 01902 308050

Fax: 01902 308051

E-Mail: info@henry-squire.co.uk

Website: www.squirelocks.co.uk